

MWPS-74001

Insulated Pump House Plan

This plan details a small wood frame building with a hinged roof for housing pumps, pressure tanks and motors.

CAUTION!

Additional professional services will be required to tailor this plan to your situation, including but not limited to: assurance of compliance with codes and regulations; review of specifications for materials and equipment; supervision of site selection, bid letting and construction; and provision for utilities, waste management, roads or other access. **Furthermore, any deviation from the given specifications may result in structural failure, property damage, and personal injury including loss of life.**

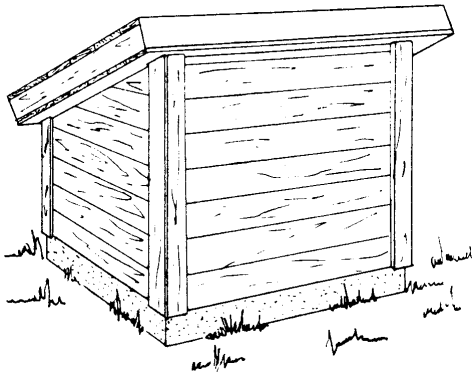

MIDWEST PLAN SERVICE		
ARK.	COOPERATIVE EXTENSION WORK IN AGRICULTURE AND HOME ECONOMICS	NEB.
ILL.	PLANS PREPARED BY	N. D.
IND.	NORTH CENTRAL LAND GRANT COLLEGES	N. M.
IOWA	U.S. DEPT. OF AGRICULTURE COOPERATING	OHIO
KAN.	INSULATED PUMP HOUSE	OKLA.
MINN.		S. D.
MICH.		WISC.
MO.	5034	TITLE PAGE
MIDWEST PLAN NO. 74001		

WARRANTY DISCLAIMER

This plan provides conceptual information only. **Neither midwest plan service nor any of the cooperating land-grant universities, or their respective agents or employees, have made, and do not hereby make, any representation, warranty or covenant with respect to the specifications in this plan.** Additional professional services will be required to tailor this plan to your situation, including but not limited to: assurance of compliance with codes and regulations; review of specifications for materials and equipment; supervision of site selection, bid letting and construction; and provision for utilities, waste management, roads or other access.

GENERAL NOTES

BUILD HOUSE AS SMALL AS POSSIBLE. CHECK THE SIZE OF YOUR ASSEMBLED PUMP AND PRESSURE TANK BEFORE STARTING TO BUILD. POUR A GOOD QUALITY CONCRETE FOUNDATION. THE TOP MUST BE LEVEL SO THE HOUSE WILL SET EVENLY ON THE FOUNDATION. SEAL THE JOINT BETWEEN FOUNDATION AND SILL WITH CALKING COMPOUND. BE SURE TO INSTALL ROOF BRACE AS A SAFETY MEASURE. DISCHARGE DRAIN WATER THROUGH SEVERAL LENGTHS OF DRAIN TILE INTO 1/4 YARD OF GRAVEL. DO NOT RUN THE DRAIN INTO A SEWER LINE OR SEPTIC TANK. BANK THE END OF THE OVER-FLOW DRAIN WITH STRAW IN THE WINTER TO PREVENT FREEZING.

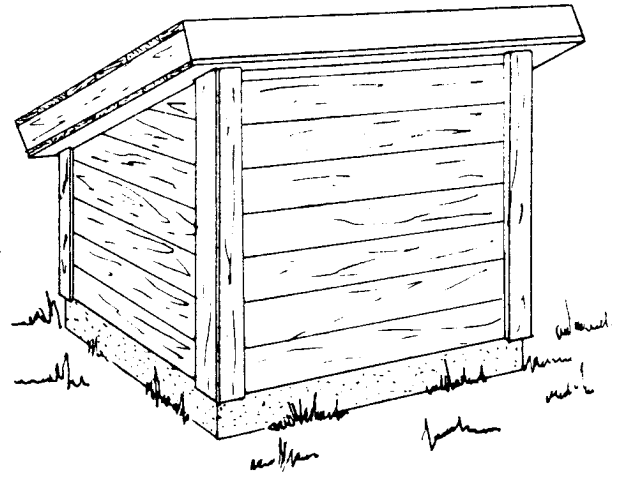

PERSPECTIVE

IMPORTANT

SAFE WIRING IS NECESSARY! RUN A SEPARATE CIRCUIT FROM THE YARD POLE TO THE WATER SYSTEM. WIRE THE WATER SYSTEM CIRCUIT BETWEEN THE METER AND THE YARD DISCONNECT SWITCH, THEN IN CASE OF FIRE, THE YARD DISCONNECT SWITCH CAN AND SHOULD BE TURNED OFF BUT THE PUMP WILL STILL OPERATE TO PROVIDE WATER TO FIGHT THE FIRE.

CONNECT ELECTRICAL GROUND TO 3/4" GALVANIZED IRON PIPE OR EQUIVALENT DRIVEN INTO THE GROUND A MINIMUM OF 8 FEET.

OPERATE 1/2 H.P. OR LARGER MOTORS ON 220/240 VOLTS.

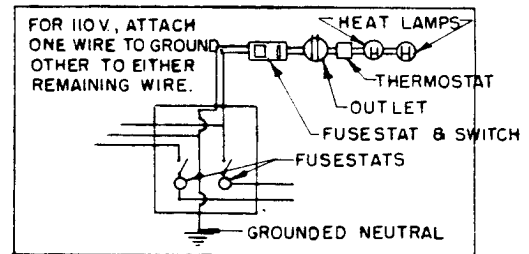

WIRING DIAGRAM

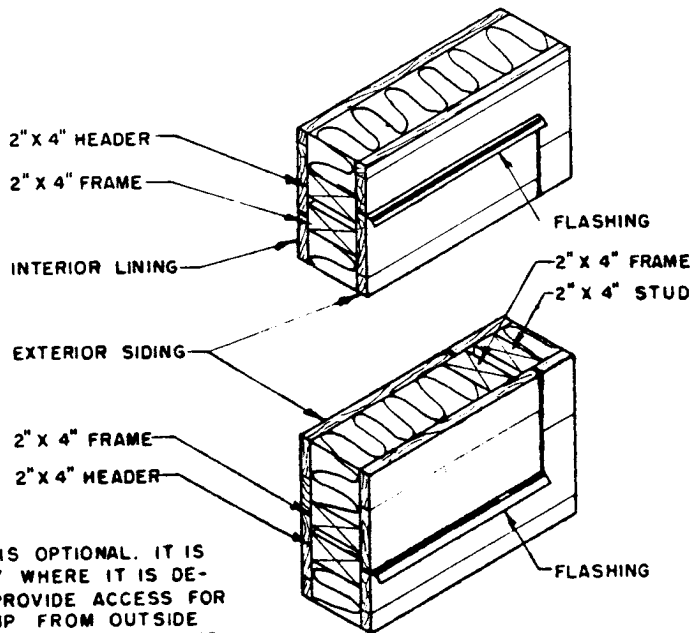

WALL PANEL IS OPTIONAL. IT IS NEEDED ONLY WHERE IT IS DESIRABLE TO PROVIDE ACCESS FOR DRIVING PUMP FROM OUTSIDE POWER SOURCE IN EMERGENCIES.

DETAIL OF REMOVABLE WALL PANEL

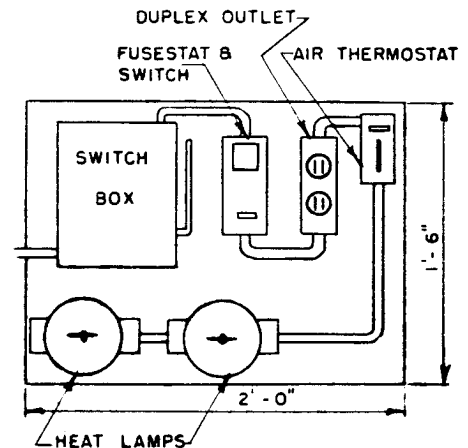

CONTROL PANEL DETAIL

SCALE 1" = 1'-0"

MIDWEST PLAN SERVICE		
COOPERATIVE EXTENSION WORK IN AGRICULTURE AND HOME ECONOMICS		
PLANS PREPARED BY NORTH CENTRAL LAND GRANT COLLEGES U. S. DEPT. OF AGRICULTURE COOPERATING		
ARK. ILL. IND. IOWA KAN. MINN. MICH. MO.	INSULATED PUMP HOUSE	
	5034	FIRST OF 1 SHEET
	MIDWEST PLAN NO. 74001	
		NEB. N. D. N. M. OHIO OKLA. S. D. WISC.